

# TSP70

HEALTHCARE SERIES/CONTROLS

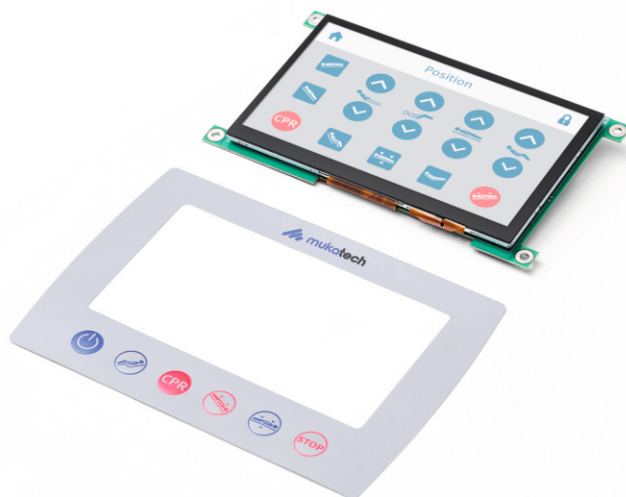

## GENERAL FEATURES

Number of Keys	7-inch capacitive touch screen
Actuator Control Capacity	max. 5
IP Code	IPX6
Housing colour	RAL7035
Operating Temperature	+5°C to +40°C
Storage Temperature	-10°C to +50°C
Software	MsBus
Function LED	No
Power Supply	With cable in Control Boxes

## DIMENSION DRAWING

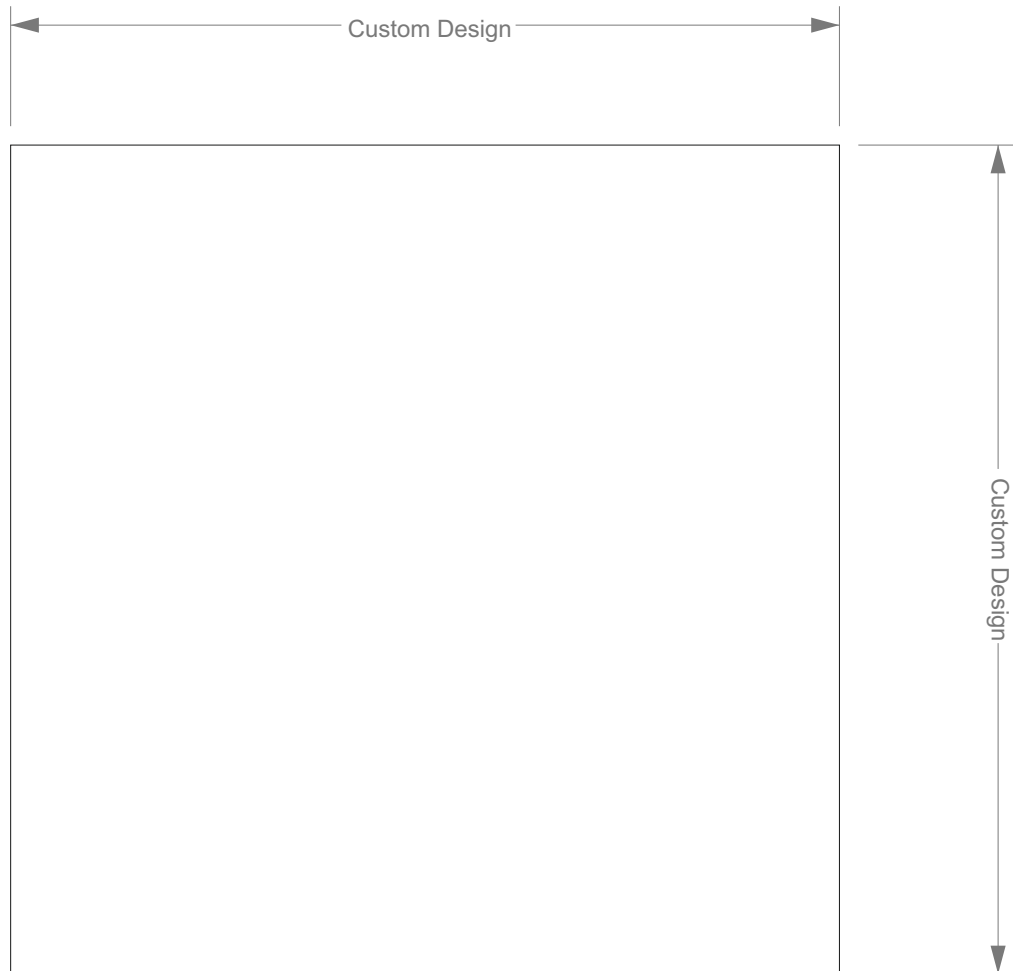

- It can be designed in all dimensions.

## ORDERING KEY

		<b>TSP</b>
System Architecture	<b>M:</b> MsBus	M
Software Code	<b>01:</b> Standard Software Code <b>XX:</b> Special Software Code The code documentation will be shared with our customers.	01
IP Degree	<b>6:</b> IPX6	6
Not used	<b>00:</b> None	00
Membrane Item Number	<b>XX:</b> Last 2 digits of frontcover item number The membrane documentation will be shared with our customers.	01
Not used	<b>0:</b> None	0
Housing Colour	<b>1:</b> RAL7035	1
Cable	<b>+</b> : Internal Cable	+
Cable Type	<b>2:</b> Flat Cable	2
Connector	<b>5:</b> Modular Jack 10P6C 180° plug <b>6:</b> Modular Jack 10P6C 90° plug	5
Cable Length	<b>7:</b> 2300mm	7

Ordering example: TSPM016000101+257

## SYSTEM COMPATIBILITY

- If the cable connector is 180 degrees, then this system is applicable.

Compatible control box models

- MCU36
- MCU36B
- MCU36L
- MCU37

TSPM016000101+257

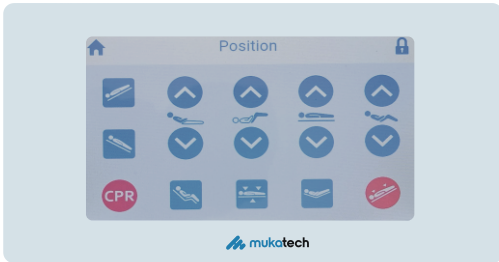

Actuator Inputs

Other compatible  
all Controls

- If the cable connector is 90 degrees, then this system is applicable.

TSPM016000101+267

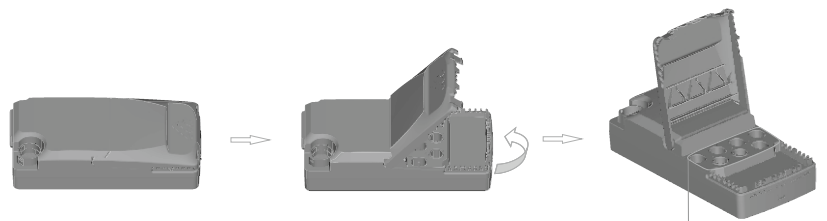
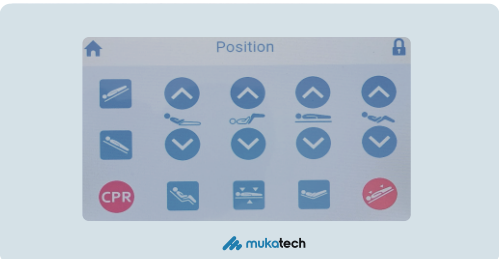

Compatible control  
box models

- MC74
- MC84
- MC86

Actuator Inputs



Battery  
Input

Other compatible  
all Controls

### Terms of Use

The user is responsible for determining the suitability of MUKATECH products for a specific application. MUKATECH products are subject to change without prior notice.

### Document Revision Information

MUKATECH 20241104 DT.REV00